

Heroes for Life



Heroes for Life

Campaign for  
Ann & Robert H. Lurie  
Children's Hospital of Chicago<sup>SM</sup>

A Presentation Prepared for  
Cal's All Star Angel Foundation

July 2010

## Ann & Robert H. Lurie Children’s Hospital of Chicago

A state-of-the-art health care facility is about much more than bricks and mortar or space and technology. Its importance lies in what it will make possible – a platform for the convergence of progressive ideas, talented people and innovative programs that will stimulate momentous breakthroughs in treatment and care.

In April 2008, ground was broken for Ann & Robert H. Lurie Children’s Hospital of Chicago, which will be located in the Streeterville community adjacent to Northwestern University’s Feinberg School of Medicine, Northwestern Memorial Hospital, Prentice Women’s Hospital and the Rehabilitation Institute of Chicago.

When it opens in 2012, Lurie Children’s will be a 23-story, 1.25 million square foot state-of-the-art facility that will:

- Be comprised of 288 beds, with the capacity to ultimately expand to 313 beds.
- Increase patient care capacity by 25 to 30 percent, accommodating up to 3,000 more inpatient admissions annually.

### FACTS AT A GLANCE

	Current	Future
Private patient room size	250 sq. ft.	290 sq. ft.
Licensed inpatient beds	270	288*
Pediatric ICU beds	48	60
Neonatal ICU beds	53	60
Surgical & procedural rooms	20	26
Imaging rooms	7	9
Emergency Department beds	25	45
Clinical research beds	2	12

\*Capacity to increase to 313



- Offer greater opportunities for clinical, academic and research collaborations with colleagues at adjacent medical and academic institutions, including Northwestern Memorial Hospital and Rehabilitation Institute of Chicago.
- Improve the transition from inpatient to outpatient care and for adolescents and young adults with chronic conditions making the transition to adult medicine.
- Contribute to care and healing through patient-centered design and the optimal organization of services.
- Attract more top tier physicians and scientists by adding space, configuration and capacity to increase faculty by as much as 25 percent.
- Expand functional space for staff and family educational activities, including, training facilities, conference areas and a family resource center.
- Stimulate a convergence of world class clinical care, research, education and advocacy to transform pediatric health care for the region and beyond.

## Creative Arts Community Partnership

A groundbreaking effort to create a powerful and innovative healing environment for children is currently underway. This project brings together some of the most creative minds from across Chicago; applying the best knowledge about children and their needs with the growing body of research about how our surroundings can impact healing.

The unique environment of Ann & Robert H. Lurie Children's Hospital of Chicago will feature opportunities for exploration, learning and discovery throughout Chicago. The Creative Arts Community Partnership will excite those who wish to bring elements of the outside world into the hospital where they can impact the health and healing of children and families.

Since the beginning of this project, the motto has been, "Everyone has a hand in it." Patients and families have been an integral part of design decisions. Our Kids' Advisory Board, a group of 10 teenagers who have had significant experiences at Children's Memorial have been meeting monthly with new hospital project leaders, architects and designers to ensure that we are creating a healing environment at Lurie Children's that will allow for state-of-the-art, family-centered care.

## Creating a Unique Place of Healing

Early on in the planning for the new facility, it became evident that we wanted to create a different kind of children's hospital; a world-class center for pediatric medicine and science in the heart of Chicago. We recognized the unique opportunity to involve many of the institutions that make Chicago a world-class city in helping us to create this unique healing environment.

In March, 2008, Children's Memorial hosted the Community Partners Design Charrette, a gathering of 125 individuals from more than 20 of Chicago's most esteemed cultural and civic icons, driven by an unprecedented agenda: to "brainstorm" interior design plans for Chicago's newest children's hospital with clinicians, hospital leaders, architects and designers. The response was overwhelmingly positive, and the ideas generated that day became the platform from which the Community Partnership program was launched.

With Children's Memorial leading the effort, we began to enlist the enthusiastic participation of these organizations to provide exhibits and other design elements representing their respective mission and strengths and unified by the following vision:

- To create an environment in Lurie Children's that is warm, welcoming, engaging and calming, and one that communicates hope and promotes healing.
- To collaborate and create a unified artistic character for the entire facility that supports the theme of "Exploration" and highlights those things that make Chicago distinctive.
- To discover and establish new standards for healing atmospheres in healthcare facilities around the world.
- To develop mutually beneficial partnerships with many of Chicago's cultural and civic organizations.

## Our Community Partners

The Creative Arts Community Partnership offers an opportunity to join with creative organizations to help generations of young patients and their families.

### Exploration

- Adler Planetarium
- After School Matters
- Chicago Children’s Museum
- Chicago History Museum
- Field Museum
- Museum of Science & Industry
- Shedd Aquarium
- Chicago Symphony Orchestra
- DuSable Museum of African American History
- The Joffrey Ballet
- Little Black Pearl Art & Design Center
- Lookingglass Theatre
- Museum of Contemporary Art
- National Museum of Mexican Art/Yollocalli Arts Reach
- Redmoon Theater
- Snow City Arts

### Nature and Wildlife

- Chicago Botanic Garden
- Lincoln Park Zoo
- Peggy Notebaert Nature Museum

### Arts and Culture

- The Art Institute of Chicago
- Chicago Architecture Foundation
- Chicago Cultural Alliance

### Great Neighbors

- Chicago Fire Department
- City of Chicago Department of Cultural Affairs
- American Dental Association



The calming, aquatic themed entrance to the Kenneth and Anne Griffin Emergency Care Center

### The 17<sup>th</sup> Floor: A Healing Environment for Cancer Patients

Ann & Robert H. Lurie Children's Hospital of Chicago will include dramatic improvements in the facilities, technology, and support spaces that we provide for patients and families served by the Division of Hematology, Oncology, and Stem Cell Transplantation. In the planning of the new facility, we have taken full advantage of this unique opportunity to incorporate cutting edge technology, as well as a flexible infrastructure to accommodate new inventions and discoveries.

#### Unique elements planned for the 17<sup>th</sup> floor playroom

Below is a sample of representative items that are planned for the playroom when Ann & Robert H. Lurie Children's Hospital of Chicago opens its doors in 2012:

- Matted, contained play corner
- Flat screen TV
- Wii, PlayStation 3, and Xbox 360 video game systems
- iPads to be mounted on a round table for group activities (i.e.; virtual futsal)
- Flat screen computer with webcam
- Subscriptions to various magazines popular with teens
- Interactive dry erase board
- Play kitchen area
- Train table
- Art/craft supplies
- Board games/puzzles
- Magnetic dart board
- Bulletin board or display case
- Adapted toys for children with special needs
- iPod and interactive music station for teens

#### Community Partnership: Chicago Children's Museum

The Chicago Children's Museum's overall goal is to partner with Lurie Children's Hospital and design an experience for children, families, caregivers and staff on the 17<sup>th</sup> floor that is serene and comforting, while also surprising and inspiring.

The proposed concept is based, in part, on CCM's work exploring universal themes of children's play. CCM's Conceptual Framework: *Imagine Childhood* is one result of this exploration. Some of the best visitor experiences currently being developed at the Museum are based on these universal themes of play, which include nature and art. Children have an affinity for the outdoors and the natural world. And art captures children's abilities and inclination for self-expression, creativity, and imagination.

#### Design Strategies

Chicago Children's Museum proposes the following features for each designated area on the 17<sup>th</sup> floor:

##### Location #1: Interactive Feature Area

The Glen: A nature-inspired respite experience

*An inviting, nature-inspired space for patients and families to gather, converse, explore, meet new friends, and spend time with one another. This space is also a place for children and caregivers to sit quietly, if needed.*

## Heroes for Life

The space attracts all ages- teenagers, young children and adults feel equally comfortable. This is a space that seems to be a breath of fresh air, bringing in elements of the outdoors, into an environment where children and families don't often receive a change of scenery.

Goals for the Experience:

- Children and families may explore the space physically by navigating through, sitting, or lounging on interesting natural structures.
- Children and families will have multi-sensory experiences including visual and tactile interactions with materials and textures, and auditory experiences with natural sounds.
- Children and families will be inspired to “hang out,” connect, and engage in conversations.
- Children and families may use the space as a soothing escape to calm nerves, refocus, and relax.

### Location #2: Four Shadow Boxes or Low-relief panels

Ceramic Landscape Portraits: The Dunes, the Lake, the Prairie, the Woodlands - Sculpted by children

Children interpret their impressions of four topographical zones found in Illinois – dunes, lake, prairies and woodlands. Each completed ceramic portrait is created by 4 ceramic tiles – each tile individually created by a different child. When the four ceramic tiles are put together in a square format, the grouping forms a topographical representation.

Goals for the Experience:

- Children and families will enjoy a multi-sensory experience, both visual and tactile.
- Children and families may be inspired to talk about their own experiences in these environments, or create/recall favorite stories that take place in these settings.

### Locations #3, #4, and #5: Path of Discovery Panels

Three Chicagoland Photo Panoramas

Each Path of Discovery will be a photo panorama (made up of 4 photos) featuring a Chicagoland icon and its surrounding environs. On closer observation by the viewer each panorama (made up of four panels) is also a narrative or adventure story featuring a character such as a bird, a frog, or a child. There is movement and narration from one panel to the next like an old-fashioned filmstrip. For example, a frog hops along Michigan Ave. and finds itself larger than life reflected in the Bean; or a bird flies across Addison St. and lands on Wrigley Field.

Goals for the Experience:

- Children and families will have a visual experience: whether they look quickly or closely at the photos.
- Children and families will experience a story narrative, as they move along the photos.
- Children and families may engage their imaginations and be inspired to continue a dialogue about the characters, places, and events in the photos.

## Heroes for Life

### Locations # 6, #7, #8 and #9: *Discovery Boxes*

#### Small Worlds

Each Discovery Box will feature collections of objects – pebbles, shells, gems, bark, dried flowers, bird nests, seeds – arranged to create beautiful miniature landscapes and magical fairyland dioramas. The children who are patients will have the opportunity to add to or take something out of the small worlds at special occasions, such as entering or leaving the hospital, a milestone in their treatment, or a birthday. Chicago Children’s Museum will supply the Hospital with a “treasure box” of loose pieces from which the children can choose.

#### Goals for the Experience:

- Children and families will engage their imaginations as they enter into the small worlds through their minds.
- Children and families may invent characters and stories inspired by the scenes.
- On special occasions, children will experience self-expression and the ability to “leave one’s mark” as they add or take away items from the miniature worlds.

### Location #10 (Hallway): *Artwork*

#### City in a Garden Mural by children

A colorful mural will be created cooperatively by children under a unified theme of City in a Garden.

#### Goals for the Experience:

- Children and families will have the chance to connect to their greater surroundings: the city of Chicago, and gain a sense of place.
- Children and families will enjoy the visual experience of exploring a mural.

### Location #11 (Adjacent Waiting Room): *Flat Artwork*

#### The Art of Poetry and Gardens (children create artwork based on poetry)

Each flat artwork, will be composed of artwork created by children, all based on a poem about gardens or nature. Each 36” x 48” format will feature a beautifully printed poem at its center, surrounded by smaller canvases created by children and staff from Children’s Memorial Hospital, children and staff from Chicago Children’s Museum, and professional artists interpreting the theme of the poem. There will be the opportunity to include a translation of each poem into Spanish, Polish and Arabic.

This approach combines a literacy and visual element to the flat artwork. Given that the location of these paintings is adjacent to the Waiting Room, the viewers will be able to get close to the artwork to easily read the poems and view the paintings.

#### Goals for the Experience:

- Children and families will have the opportunity to engage deeply with the artwork, reflecting on the poem and looking at the details of a number of small canvases.
- Children and families may be inspired to engage in conversation about the poem or about details found in the small paintings.

## Heroes for Life

### Location #12 (Family Great Room): 2D Art Work

#### Google Earth

An engaging and beautiful image of Lake Michigan and Chicago lakefront and beyond will be located in the family room. The image will be reproduced photographically and printed on Plexiglas so that it can become an interactive element in this space.

Children's Memorial Hospital of Chicago will be located as will the Ferris wheel at Navy Pier to indicate the current location of Chicago Children's Museum. Viewers can draw on the image based on accompanying "story starters" such as: *Where's your favorite place to watch a baseball game? When you go home, which direction do you go?* Younger visitors may just enjoy drawing on the shapes, colors and forms that occur on the map.

#### Goals for the Experience:

- Children and families will be able to gain a sense of their greater surroundings, including the city of Chicago and environs.
- Children and families may engage in conversation about the map, Chicago, where they live, the lake, the city, etc.
- Children and families will use fine and gross motor skills to create large-scale drawings.
- Children and families will explore self-expression while drawing and will explore basic elements of art including line, shape and color.

### Location #14 (Family Great Room): 3-D Artwork

#### Thank You

This small artwork will be a gift from Chicago Children's Museum as thanks for being able to contribute to the great work being done at the Ann & Robert Lurie Children's Hospital.

#### Goal for the Experience:

- Children and families will be inspired to look closely at the details of the artwork.
- Children and families may be inspired to seek and find items in the artwork, invent stories, and explore the space with their imaginations.

## Join us on our journey

The support of Cal's All Star Angel Foundation will help to sustain the healing atmosphere for all patients and families who are served by the 17<sup>th</sup> floor of Ann & Robert H. Lurie Children's Hospital of Chicago.

Very rarely do hospitals have the chance to begin again – to rebuild – to look to the future through a new prism and plan for every aspect of care. We are seizing this historic opportunity to make our new facility truly family-centered and unique to Chicago, designed to serve children's social, psychological and developmental needs.

Your support of *Heroes for Life* will strengthen our ability to accommodate children and their families during the greatest time of need. A world-class hospital will enhance the quality of life in our community and raise the bar for medical care and treatment of our children, transforming pediatric healthcare in the city of Chicago, the region and beyond.

17<sup>th</sup> Floor Key Plan

Key #	Description
1	Interactive Feature Area
2	Shadow Box
3	Path of Discovery
4	Path of Discovery
5	Path of Discovery
6	Discovery Box
7	Discovery Box
8	Discovery Box
9	Discovery Box
10	Art Work
11	Art Work
12	Art Work/2D: Family Great Room
14	Art Work/3D: Family Great Room

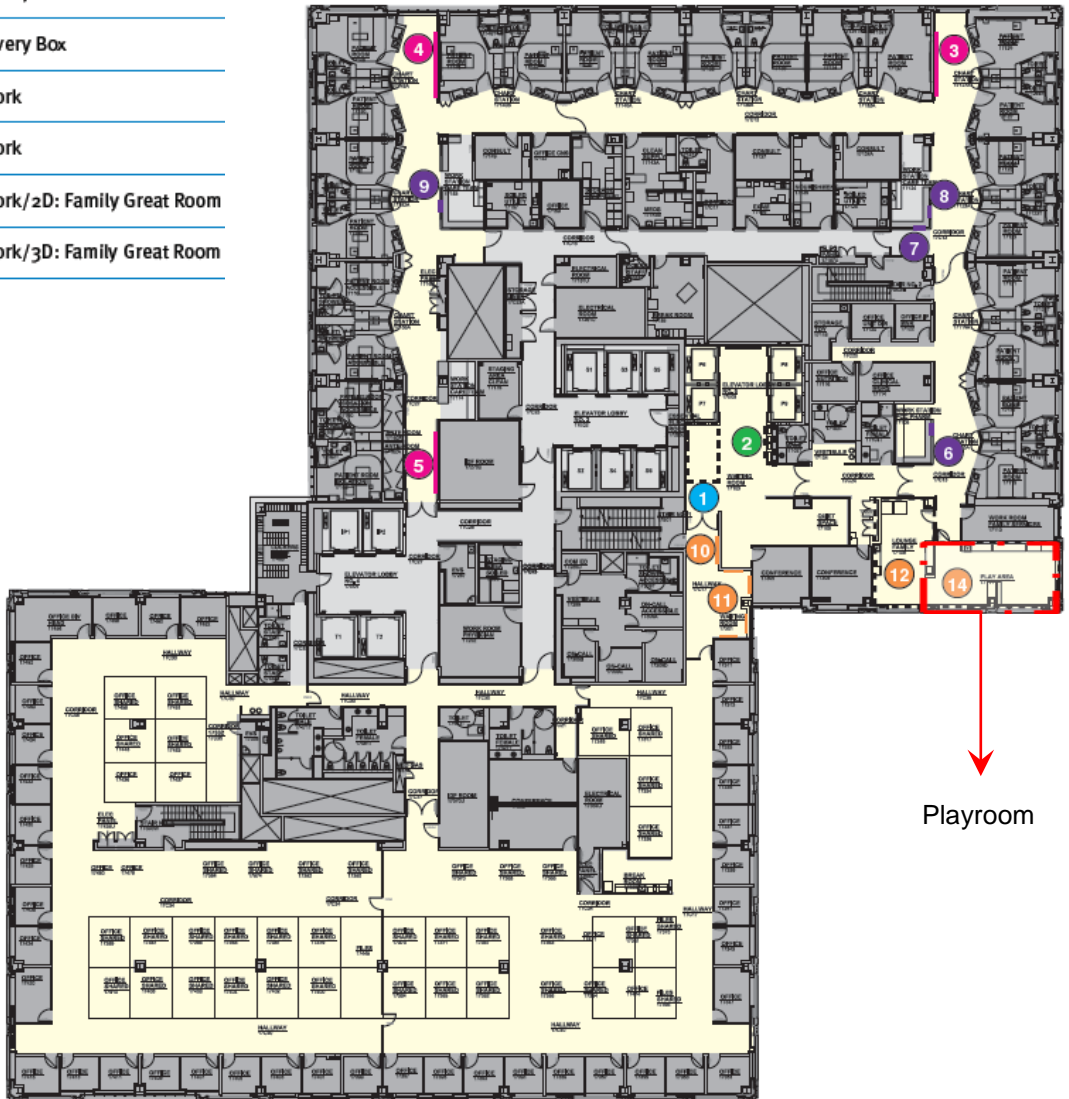

Playroom